



CENTURY BOULEVARD COMPLETE STREET FEASIBILITY STUDY

Public Meeting

March 15, 2025



Tighe&Bond

PROJECT SITE – AVAILABLE WIDTHS



PERPENDICULAR PARKING ON CENTURY BOULEVARD

- Creates a vehicular focused Century Boulevard
- Requires more space for parking, reducing space for sidewalks, street trees, and green infrastructure
- Need to cross into oncoming traffic to enter or exit parking space
- 151 Parking spaces shown (including 6 accessible); 12'-0" travel lanes

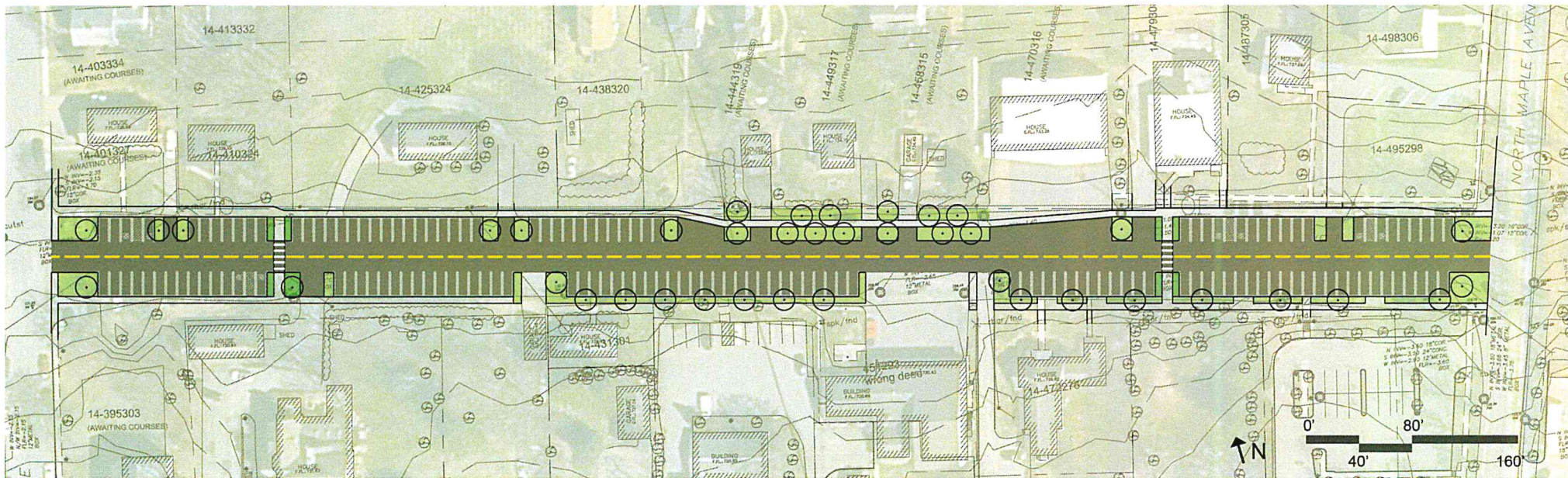

OPTION A – PEDESTRIAN FOCUSED

- Angle parking reduces amount of space required and provides more space for continuous sidewalk
- Continuous sidewalk provided on north side of Century Boulevard
- Includes two mid block crosswalks
- 67 Parking spaces shown (including 3 accessible), 12'- 0" travel lanes

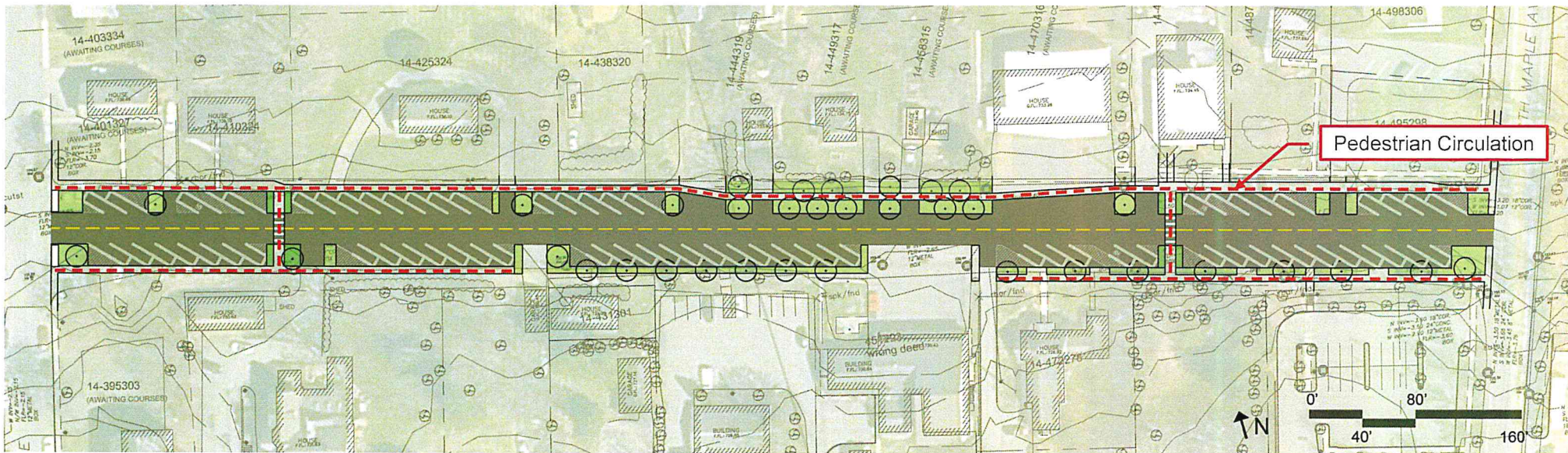

OPTION B– GREEN INFRASTRUCTURE FORWARD

- Angle parking reduces amount of space required for parking
- Parking and sidewalk aligned on north edge of Century Boulevard to increase space on the south side of Century Boulevard for green infrastructure
- South side of Century Boulevard ideal for green infrastructure as natural drainage pattern flows to the southeast.
- One mid block crosswalk
- 68 Parking spaces shown (including 3 accessible), 11'- 0" travel lanes

